

- 18MM BACKING AS PER APPROVED VENEER AND STAIN
- 40MM THK SHELF WITH BEECH WOOD LIPPING AS PER APPROVED VENEER AND STAIN WITH STRIP LIGHT (WARM WHITE)
- MDF SHUTTER WITH MOULDING AND CARVING AS PER APPROVED VENEER AND STAIN
- 55MM THK. SHELF WITH BEECH WOOD LIPPING AS PER APPROVED VENEER AND STAIN WITH STRIP LIGHT (WARM WHITE)

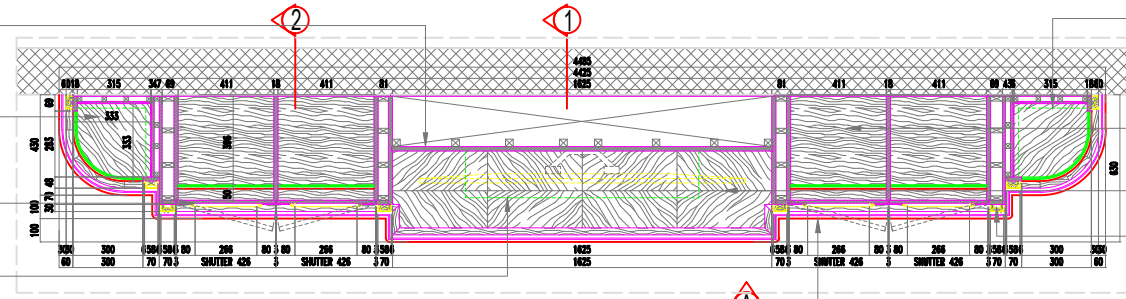

SECTION PLAN 1
SCALE 1:10

- STRIP LIGHT (WARM WHITE)
- 40MM THK SHELF WITH BEECH WOOD LIPPING AS PER APPROVED VENEER AND STAIN
- MDF TOP AS PER APPROVED VENEER AND STAIN
- BEECH WOOD COLUMN DESIGN AS PER APPROVED STAIN AND CARVING AND GROOVES IN GOLD LEAF FIN.
- BEECH WOOD LIPPING TOP

- 6MM BACKING AS PER APPROVED VENEER AND STAIN
- MDF DRAWER AS PER APPROVED VENEER AND STAIN
- MDF SHUTTER WITH MOULDING AND CARVING AS PER APPROVED VENEER AND STAIN
- MDF DRAWER FACE WITH MOULDING AND CARVING AS PER APPROVED VENEER AND STAIN

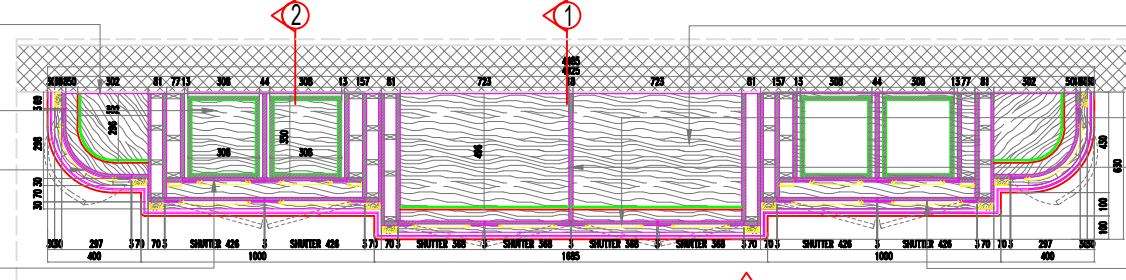

SECTION PLAN 2
SCALE 1:10

- 40MM THK SHELF WITH BEECH WOOD LIPPING AS PER APPROVED VENEER AND STAIN
- MDF SHUTTER WITH MOULDING AND CARVING AS PER APPROVED VENEER AND STAIN
- MDF PARTITION AS PER APPROVED VENEER AND STAIN
- MDF SHUTTER WITH MOULDING AND CARVING AS PER APPROVED VENEER AND STAIN

- 18MM MDF AS PER APPROVED VENEER AND STAIN
- BEECH WOOD LIPPING TOP PANEL AS PER APPROVED STAIN AND STRIP LIGHT INSIDE
- 6MM BACKING AS PER APPROVED VENEER AND STAIN
- 55MM THK. SHELF WITH BEECH WOOD LIPPING AS PER APPROVED VENEER AND STAIN WITH STRIP LIGHT (WHITE)
- 18MM BACKING AS PER APPROVED VENEER AND STAIN
- 6MM BACKING AS PER APPROVED VENEER AND STAIN
- 55MM THK. SHELF WITH BEECH WOOD LIPPING AS PER APPROVED VENEER AND STAIN WITH STRIP LIGHT (WARM WHITE)
- BEECH WOOD LIPPING TOP
- BEECH WOOD COLUMN DESIGN AS PER APPROVED STAIN AND CARVING AND GROOVES IN GOLD LEAF FIN.
- BEECH WOOD MOULDING AS PER APPROVED STAIN
- BEECH WOOD CARVING WITH GOLD LEAF FIN.
- MDF SHUTTER AS PER APPROVED VENEER AND STAIN
- BEECH WOOD SKIRTING AS PER APPROVED STAIN

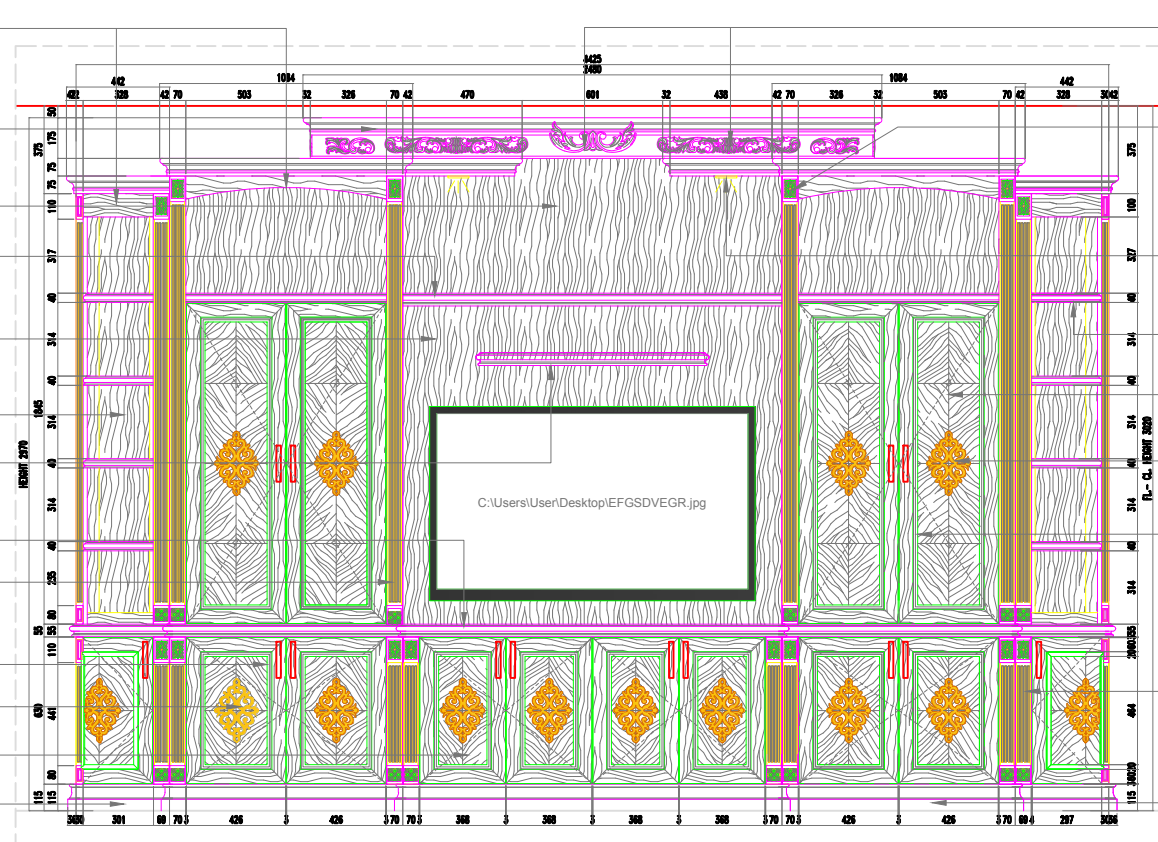

ELEVATION A
SCALE 1:16

- BEECH WOOD CARVING WITH GOLD LEAF FINISHED
- BEECH WOOD COLUMN DESIGN AS PER APPROVED STAIN AND CARVING AND GROOVES IN GOLD LEAF FIN.
- SPOT LIGHT
- 40MM THK SHELF WITH BEECH WOOD LIPPING AS PER APPROVED VENEER AND STAIN WITH STRIP LIGHT (WARM WHITE)
- MDF SHUTTER AS PER APPROVED VENEER AND STAIN
- BEECH WOOD CARVING WITH GOLD LEAF FIN.
- BEECH WOOD MOULDING AS PER APPROVED STAIN
- BEECH WOOD COLUMN DESIGN AS PER APPROVED STAIN AND CARVING AND GROOVES IN GOLD LEAF FIN.
- BEECH WOOD SKIRTING AS PER APPROVED STAIN

- BEECH WOOD LIPPING TOP PANEL AS PER APPROVED STAIN
- STRIP LIGHT (WHITE)
- BEECH WOOD LIPPING AS PER APPROVED STAIN
- SPOT LIGHT
- 6MM BACKING AS PER APPROVED VENEER AND STAIN
- BEECH WOOD LIPPING AS PER APPROVED STAIN
- BEECH WOOD LIPPING AS PER APPROVED STAIN
- STRIP LIGHT (WHITE)
- STRIP LIGHT (WARM WHITE)
- 18MM BACKING AS PER APPROVED VENEER AND STAIN
- BEECH WOOD LIPPING AS PER APPROVED STAIN
- MDF SHUTTER AS PER APPROVED VENEER AND STAIN
- 40MM THK SHELF WITH BEECH WOOD LIPPING AS PER APPROVED VENEER AND STAIN
- BEECH WOOD MOULDING AS PER APPROVED STAIN
- BEECH WOOD SKIRTING AS PER APPROVED STAIN

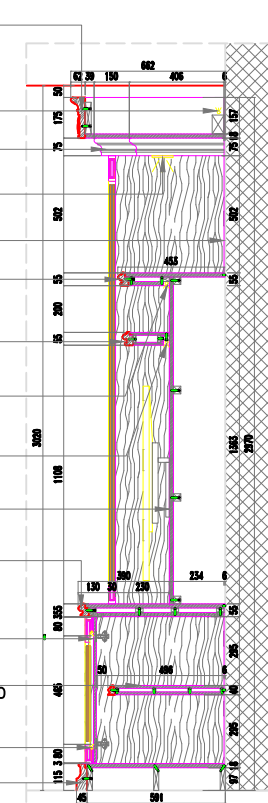

SECTION 1
SCALE 1:16

- BEECH WOOD LIPPING TOP PANEL AS PER APPROVED STAIN
- 18MM MDF AS PER APPROVED VENEER AND STAIN
- STRIP LIGHT (WHITE)
- SPOT LIGHT
- 55MM THK. SHELF WITH BEECH WOOD LIPPING AS PER APPROVED VENEER
- 40MM THK SHELF WITH BEECH WOOD LIPPING AS PER APPROVED VENEER AND STAIN
- MDF SHUTTER WITH MOULDING AND CARVING AS PER APPROVED VENEER AND STAIN
- MDF DRAWER AS PER APPROVED VENEER AND STAIN
- MDF DRAWER FACE WITH MOULDING AND CARVING AS PER APPROVED VENEER AND STAIN
- MDF SHUTTER WITH MOULDING AND CARVING AS PER APPROVED VENEER AND STAIN
- BEECH WOOD SKIRTING AS PER APPROVED STAIN

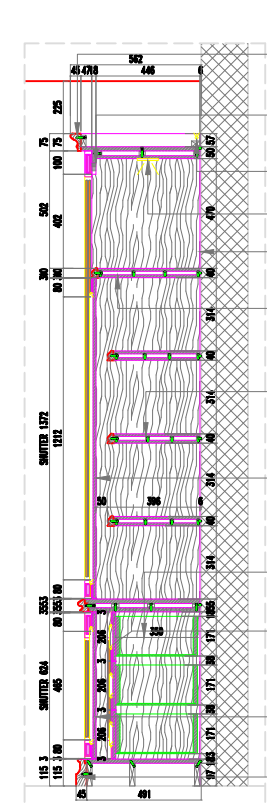

SECTION 2
SCALE 1:16